

GP40-2/GP40P-2

NOTICE
All instructions, warranties and other collateral documents are subject to change at the sole discretion of Horizon Hobby, LLC. For up-to-date product literature, visit athearn.com and click on the support tab for this product.

Meaning of Special Language
The following terms are used throughout the product literature to indicate various levels of potential harm when operating this product:
WARNING: Procedures, which if not properly followed, create the probability of property damage, collateral damage, and serious injury OR create a high probability of superficial injury.
NOTICE: Procedures, which if not properly followed, create a possibility of physical property damage AND a little or no possibility of injury.

WARNING: Read the ENTIRE instruction manual to become familiar with the features of the product before operating. Failure to operate the product correctly can result in damage to the product, personal property and cause serious injury. This is a sophisticated hobby product. It must be operated with caution and common sense and requires some basic mechanical ability. Failure to operate this Product in a safe and responsible manner could result in injury or damage to the product or other property. This product is not intended for use by children without direct adult supervision. Do not attempt disassembly, use with incompatible components or augment product in any way without the approval of Horizon Hobby, LLC. This manual contains instructions for safety, operation and maintenance. It is essential to read and follow all the instructions and warnings in the manual, prior to assembly, setup or use, in order to operate correctly and avoid damage or serious injury.

Age Recommendation: Not for Children under 14 years. This is not a toy.
PLEASE NOTE:
PARTS VARY BY CAR AND/OR ROADNAME
AND ARE SUBJECT TO AVAILABILITY.

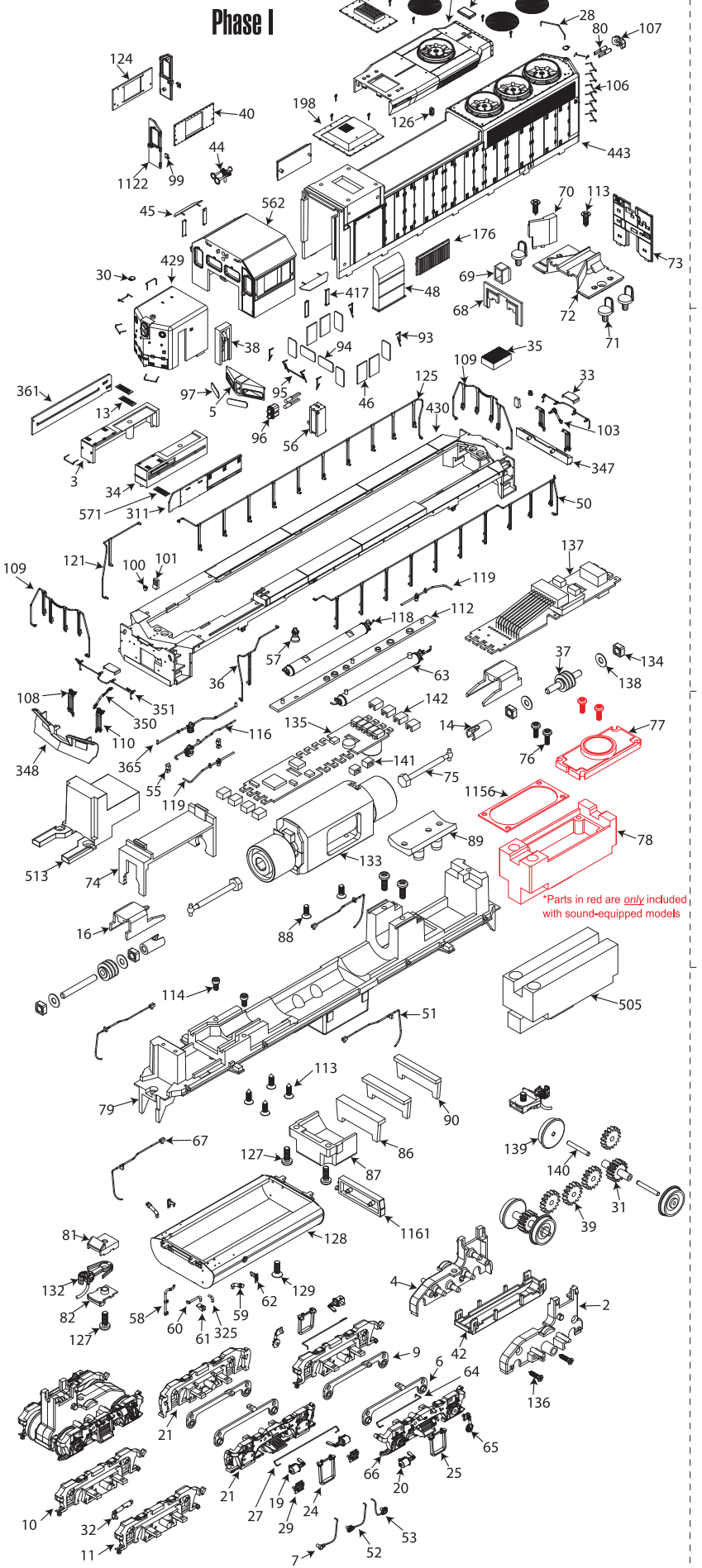

Athearn GENESIS

Thank you for purchasing your new Athearn® Genesis® HO scale model. Painstaking attention to detail has been taken to make your model "As Close to Real as it Gets™" while providing a superior drive and full-feature electronics for reliable prototypical operations.

Blending these features together provides a platform that should meet and exceed the most discriminating modeler's preferences.

*Sincerely,
The Athearn Team*

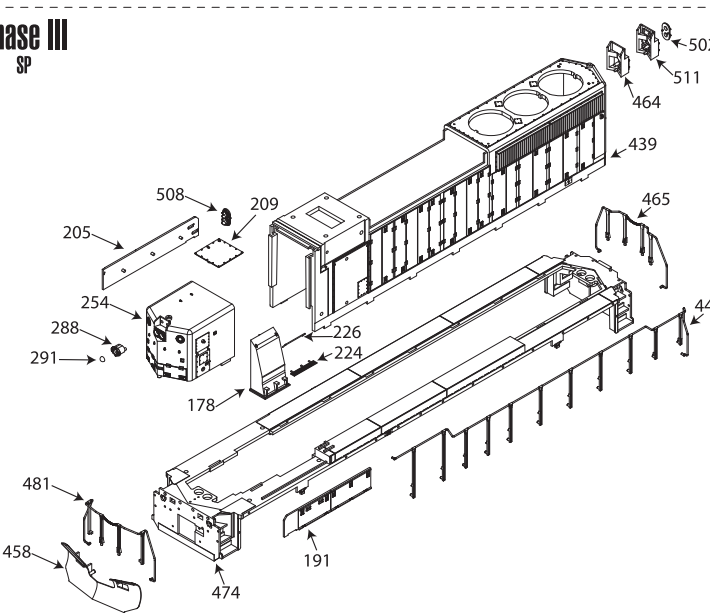
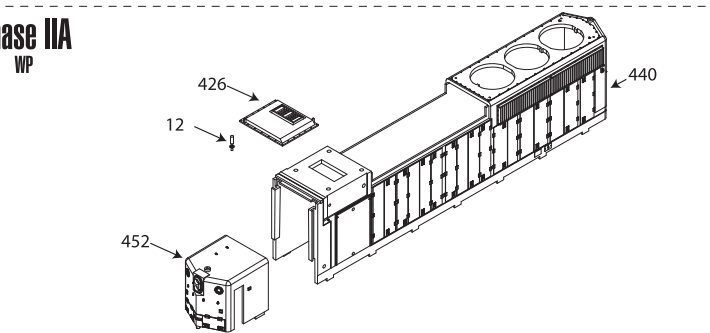
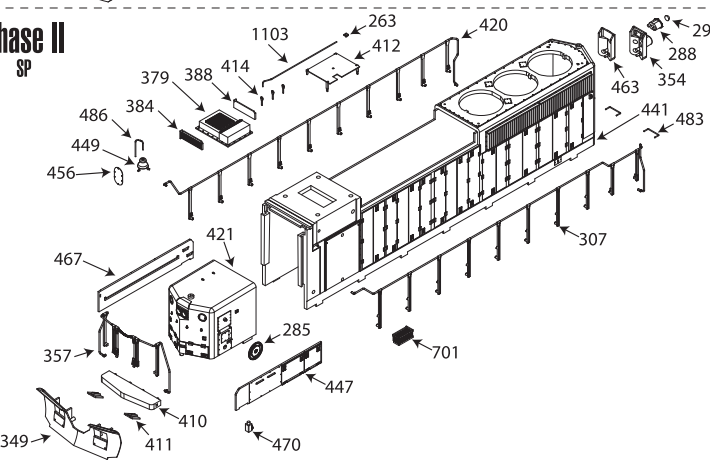
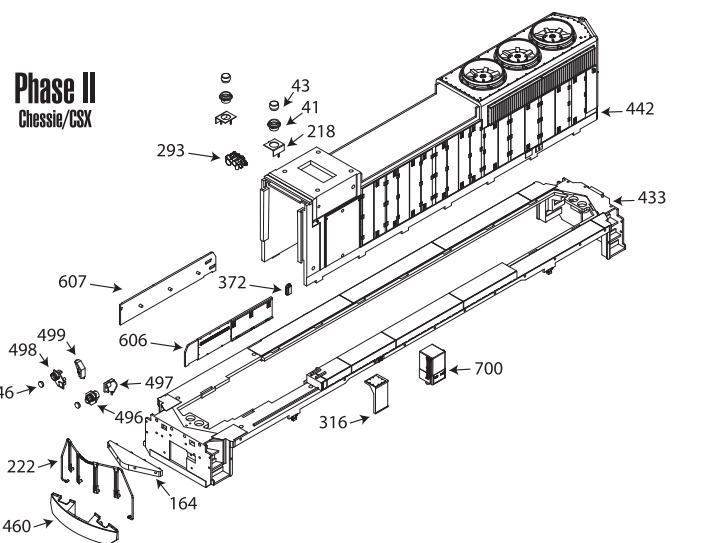

Due to the ever evolving nature of Athearn Genesis locomotives, some parts may be omitted from this list. If you are looking for a particular part that is not listed, please contact parts@athearn.com for further assistance.

GP40P-2 Phase IA
SP - Early

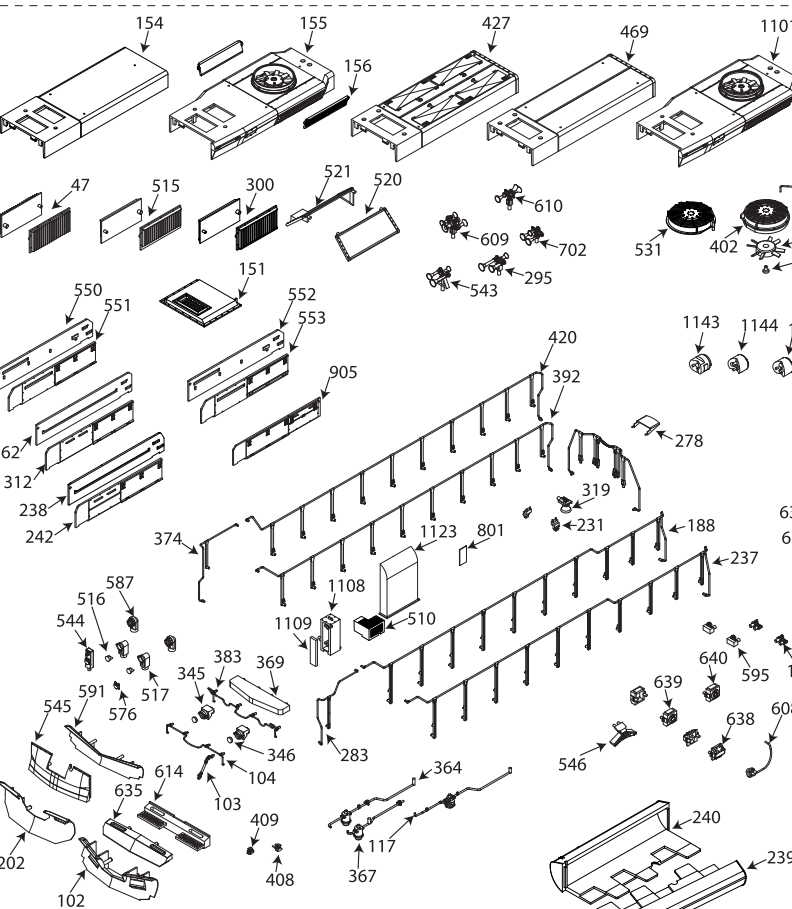

*The parts in blue show the opposite side details

GP40P-2 Phase IA
Late

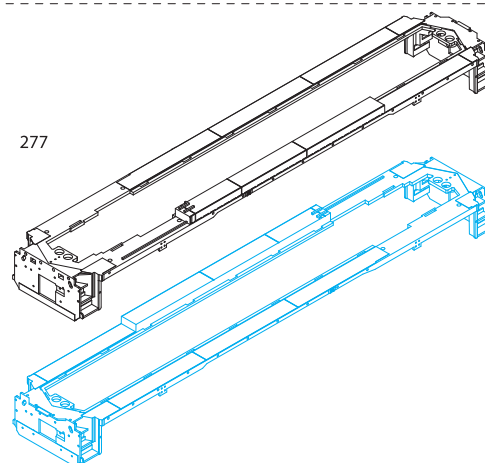
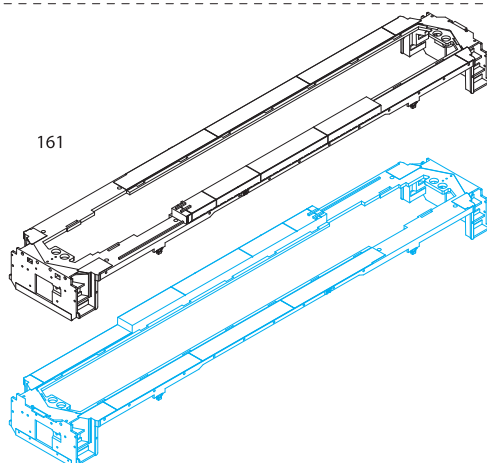
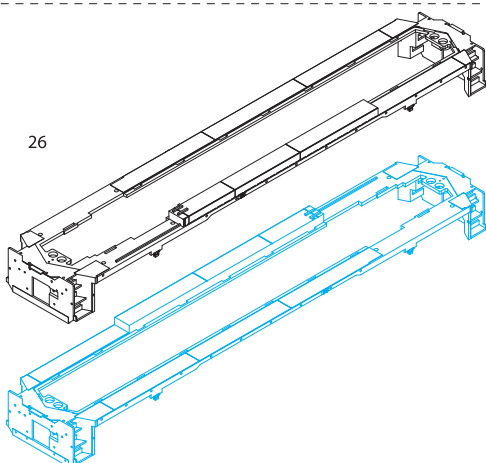
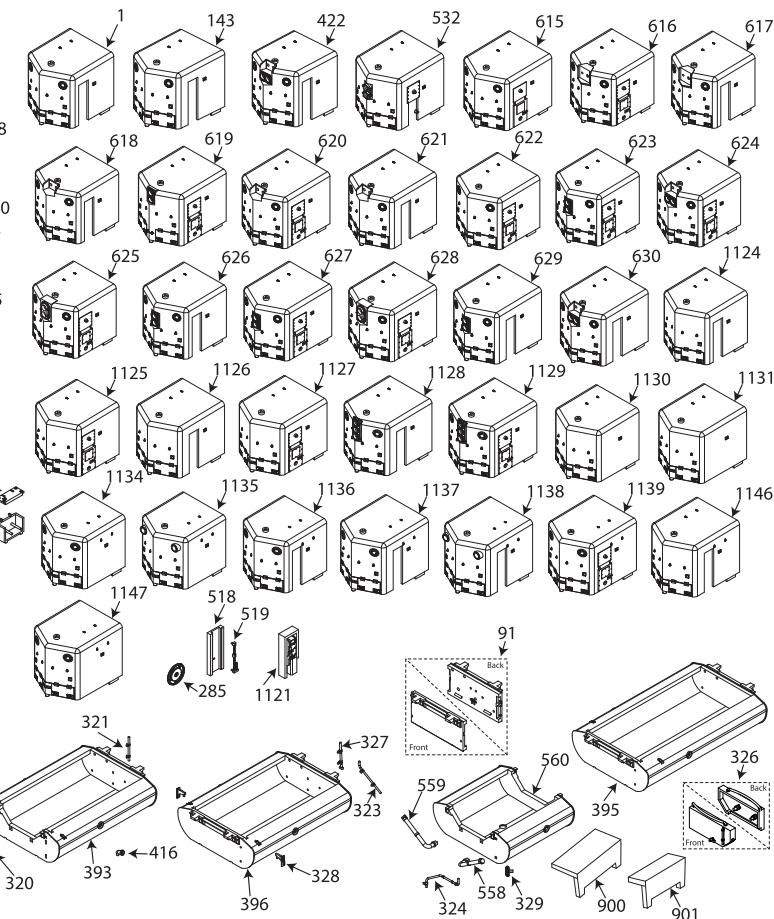
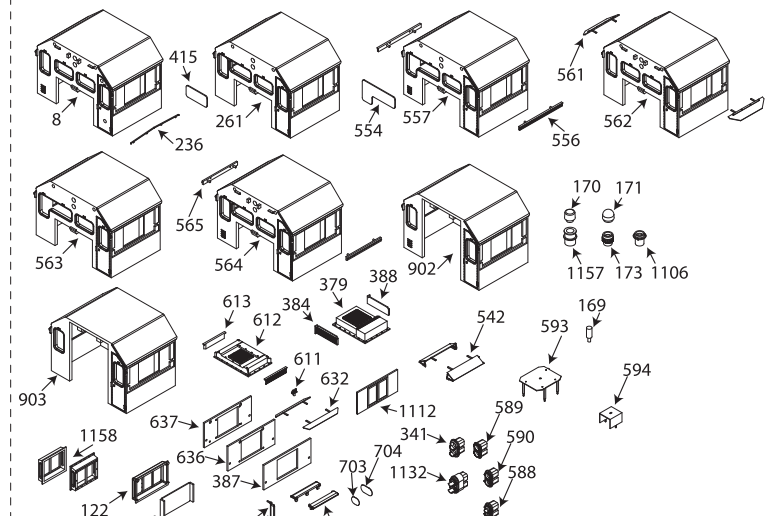

GP40-2/GP40P-2

582

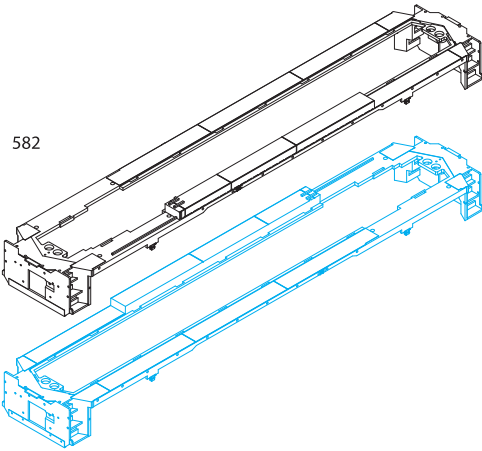

603 - With pilot face lift slots *(shown)*
604 - Without pilot face lift slots

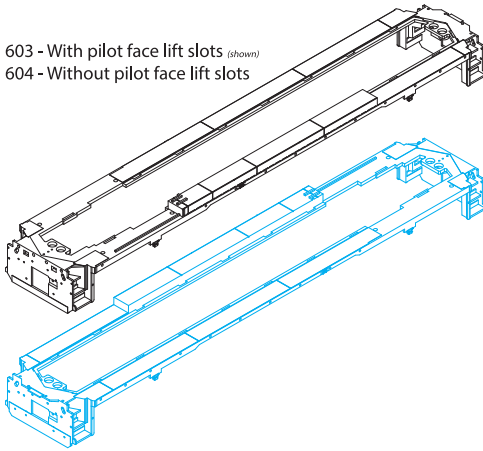

906

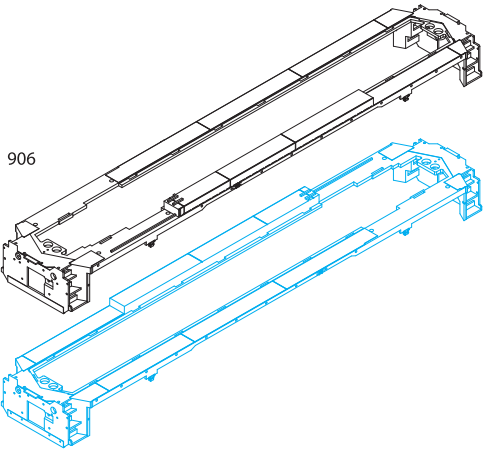

907

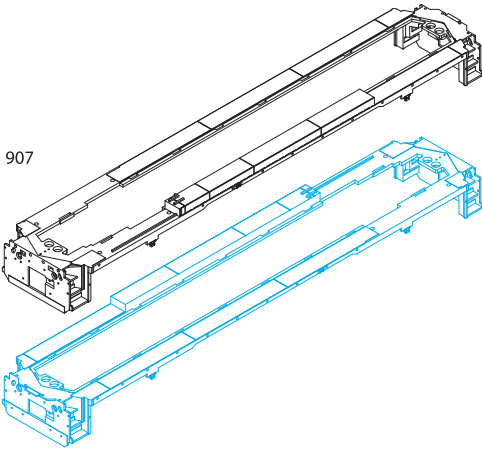

908

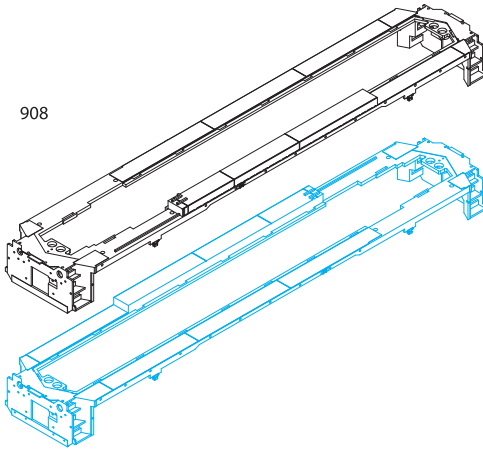

909 - Front & Rear ditch lights *(shown)*
1001 - Front *only* ditch lights

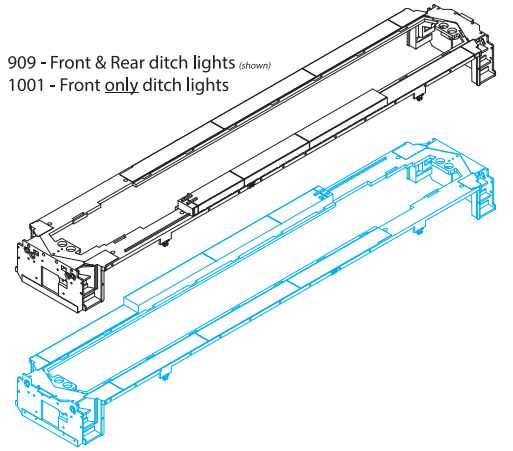

536

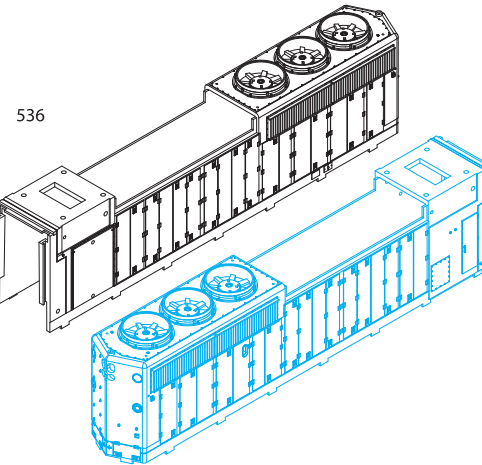

537

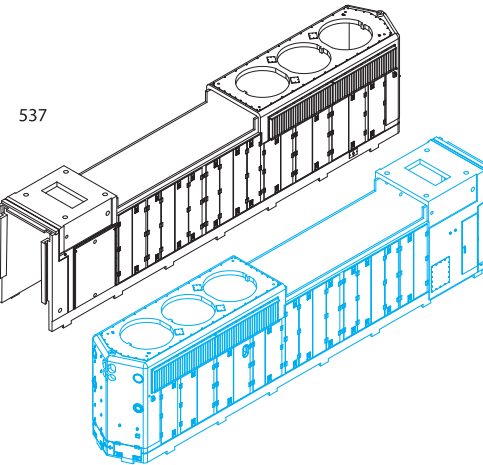

800

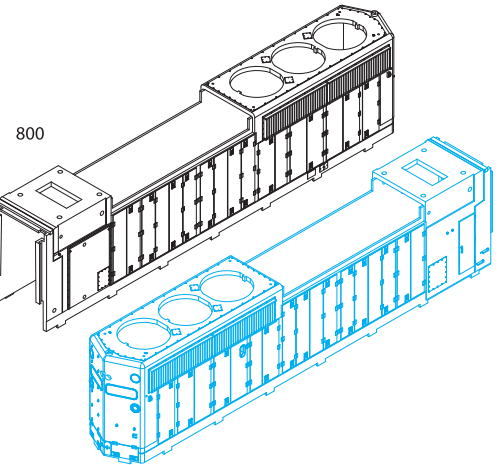

1	95305	81" Low Nose w/Ratchet Brake - No Lights
2	G62384	Gear Box - Female
3	G40265.01	Cab Sub Base - Right
4	G62383	Gear Box - Male
5	G63405.04	Number Board Housing - Standard
6	G62388	Metal Truck Sideplate - Left
7	90614.0005	Speed Recorder, Lead Axle - Late
8	G40380.01	Cab - Dash 2, Standard Early
9	G62389	Metal Truck Sideplate - Right
10	G40302.01	Blomberg-M Sideframe, Hyatt Bearings
11	G40303.01	Blomberg-M Sideframe, Timken Bearings
12	90614.0004	Firecracker Antenna
13	G40281.12	Cab Step - Rear
14	G62381	Female Coupling
16	G62382	Worm Housing
19	G62376	Brake Cylinder - Blomberg B
20	G40302.02	Brake Cylinder - Blomberg M
21	G62370	Blomberg B Sideframe
22	G40281.15	Dynamic Brake Fan Grille
23	G52328.13	Lift Ring
24	G62375	Spring Hanger - Blomberg B
25	G40302.03	Swing Hanger - Blomberg M
26	G40228	Walkway - Early, Standard
27	G68231	Air Line - Blomberg B
28	G40280.04	Radiator Fan Grab - Angled
29	G62371	Hyatt Bearing Cap
30	G40356	Sandfiller Cap - EMD, Standard Nose
31	G62386	Axle Gear - 15T
32	G40303.02	Blomberg M Anti-Hunt Strut
33	G40281.13	Drop Step - Etched
34	G40265.02	Cab Sub Base - Left
35	G40287.01	Walkway Toolbox Extension - Short
36	G40340.05	Side Short Rail - Left
37	40063	ASM Brass Worm and Shaft
38	94780	Nose Handbrake Ratchet - Dash-2
39	G62387	Idler Gear - 16T
40	G40339.01	Cab Side Plate - Riveted w/Arm Rest
41	G40371.01	Prime Stratolite Beacon Base
42	G62385	Truck Clip - Bottom
43	G40371.02	Prime Stratolite Beacon Dome
44	90614.1069	Horn - Leslie S-3LR
45	47648	Sunshade - Standard
46	80515.04	Cab Side Window Glass and Frame
47	G40275.01	Inertial Intake Grilles - Early, No Ribs
48	G40293.01	Blower Housing - Standard, Dash-2
50	G40340.03	Long Handrail - Left, GP38-2, 39-2, 40-2
51	G40309.01	Sanding Line, Single End - Front
52	90614.0006	Speed Recorder, Lead Axle - Forward Cable
53	90614.1037	Speed Recorder, Lead Axle - Forward Cable
55	G40289	Truck Light
56	95337	ECAFB ASM - Early
57	91791	Bell - Underframe Mounted
58	G40331.02	Breather Downpipe - Left, #2
59	G68249.01	Fuel Fill
60	G40331.04	Breather Up-Pipe
61	G40331.08	Breather Up-Pipe - Base
62	G68249.02	Fuel Tank Vertical Sight Glass Gauge - Standard
63	G40276.01	Air Tank - Left
64	G40360	Air Line - Blomberg M
65	G40302.04	Axle Snubber - Blomberg M
66	G40373.01	Blomberg M Sideframe
67	G40309.02	Sanding Line - Single End, Rear
68	G63911.05	Cab Front Wall - Spartan Cab
69	G63911.06	Cab Heater
70	G63911.03	Control Stand - Short Hood Forward
71	G63911.04	Cab Seat - Spartan Cab
72	G63911.01	Cab Floor - Short Hood Forward
73	G63911.02	Cab Rear Wall - Spartan Cab
74	G62019	PCB Mount
75	90125	Drive Shaft - 1.102
76	99036	Screw - PM1D7X5XHD3D5

77	90669.09	Speaker
78	G40279	Speaker Housing
79	G40261	Underframe - GP38-2, 39-2, 40-2, 50
80	G19023	Micro Light Bulb
81	G40292.01	Coupler Box
82	G40292.02	Coupler Box Cover
85	G40331.30	Fuel Tank Front Plate
86	G40331.31	Fuel Tank Filler Plate - Top, 156" (3.96mm)
87	G40263	Fuel Tank Weight
88	99012	Screw - KM1D9X5XHD3D6
89	G62018	Motor Mount
90	G40331.32	Fuel Tank Filler Plate - Top, 114" (2.90mm)
91	G40331.33	Fuel Tank End Plate
93	G68915.04	Windshield Wiper, Single - Outer Windows
94	80515.01	Cab Front/rear Window Glass, Sides
95	G68223.03	Windshield Wiper - Double
96	G40283.02	Headlight - Dual Sealed Beam w/Glare Shield
97	80515.05	Cab Number Board Glass
99	G60181.05	Cab Door Handle
100	G40278.02	MU Receptacle - Deck Mount
101	G40278.01	MU Stand - Deck mount, Single Receptacle
102	G67724	Snowplow - EMD Low, Standard
103	G40288.01	Trainline Hose
104	G40291.01	Coupler Cut Lever - Early
106	G62327.05	Grabiron - Drop
107	G40283.01	Rear Headlight Housing - EMD Standard
108	G67034.01	Signal Hoses - Left
109	G40340.01	Front/Rear End Rail - No Anticlimber, Standard
110	G67034.02	Signal Hoses - Right
112	G40276.03	Blower Duct - Bottom Plate
113	99010	Screw - KB1D8X6D35XHD3D6
114	99040	Screw - PM1D8X3D5XHD3
116	G40290.02	Salem Air Filter w/Piping - #1
117	G40290.03	Salem Air Filter w/Piping - #2
118	G40276.02	Air Tank - Right
119	G40290.01	Brake Vent Regulator Valve
120	G63450.01	Spare Knuckle & Bracket - Pilot or Sideframe Mount
121	G40340.04	Short Handrail - Right (for Standard Stepwells)
122	G68222.01	3-Pane All Weather Window
123	G68222.02	3-Pane All Weather Window Glass
124	G40339.03	Cab Side Plate - Riveted, No Arm rest
125	G40340.02	Long Handrail - Right
126	G40273.06	Sight Glass - Long Hood
127	99002	Screw - PM2D1X6XHD4D1
128	G40398	3600 Gal Fuel Tank
129	99007	Screw - KM2D1X6D2 HD4D2
131	G40331.07	Fuel Tank Drain Bar
132	90615	McHenry Coupler
133	G62015.2	Genesis Motor
134	40052	Bearing
135	T0204.xxxx	SoundTraxx Tsunami2 Soundboard
136	G63847	Screw - KB1D5X6D7XHD2D7
137	G63868	DCC Adapter Board
138	G62021	Washer
139	G19051	Wheel - 40"
140	G63467.01	Axle
141	63838.02	Wire Clip - #2
142	63838.03	Wire Clip - #3
143	94784	88" Nose w/ Ratchet Brake - No Lights
151	95334	Exhaust Silencer, Early, GP40-2/50, SD40-2
154	G40250	Non-Dynamic Brake Hatch - GP40-2 Post-80 and GP50
155	G40254.01	Dynamic Brake Hatch - GP39/40-2, Late (Post-1980)
156	G40255.02	Dynamic Brake Grids, GP39-2/40-2/50
161	G40236	Walkway, GP38-2/39-2/40-2, w/Anticlimber, Notched Stepwells Extra MU Receptacle Mounts - 88" Short Hoods

164	G40305.12	Anticlimber - Pointed
169	G40334	Short Firecracker Antenna - EOT
170	G68289.02	Saturn 6552 Xenon - Dome
171	G68290.02	Western Cullen Beacon Dome
173	G68290.01	Western Cullen Beacon Base
176	G40275.03	Inertial Filter Intake, GP38-2/39-2/40-2, Intermediate (Top Rib Only)

178	G40293.02	Blower Housing - Angled
188	G40349.02	GP38-2/39-2/40-2 Long Rail, Left (3 Short Stanchions)
191	80507.01	Battery Box Door Set-Latched Battery Box Dual Louver Latched, Lifting Hinge Under Cab Access Door Left
198	G40274.02	Dust Bin Hatch, GP40-2, early GP39-2
202	G40299	Snowplow, UP Medium, Late ("Flat-Top")
203	95333	Turbo Exhaust, EMD GP/SD Std. Early
204	G40253.01	Dynamic Brake Hatch, GP39/40-2, Early (Pre-1980)
205	80507.02	Battery Box Door Set-Latched Battery Box Dual Louver Latched, Lifting Hinge Under Cab Access Door Right
209	80512.03	Toilet Hatch
217	G60594	Ditchlight - EMD Flat-Top
218	90660	Stratolite Beacon Bracket - Cab Corner Mount
222	G40350.01	Front End Rail, Pointed Anticlimber w/ Std. Stanchions
224	G40281.09	Blower Housing Walkway - Angled
226	G40280.10	Blower Housing Grab Iron - Angled
228	G40280.09	Curved Fan Grab
230	G40253.03	Dynamic Brake Hatch Extended Range Contactor Door GP39-2/40-2/50
231	G40300	Extra Jack Pads, MIP
236	G40281.11	RDG Cab Rain Gutter
237	G40347.01	GP38-2/39-2/40-2 Long Rail, Left (4 Short Stanchions)
238	G68225.02	Battery Box Door W/ Stiffener Rib - Right
239	G40336.01	2900G Fuel Tank Halves - Left
240	G40336.02	2900G Fuel Tank Halves - Right
241	G60595	Ditch Light Lens - Deck Mount, EMD Standard
242	G68225.01	Battery Box Door W/ Stiffener Rib - Left
244	G40319.02	Ditchlight - Deck Mount Tall, Left
245	G40253.02	Dynamic Brake Hatch "T" Vent
247	G40319.01	Ditchlight - Deck Mount Tall w/ MU, Right
254	94782	88" Low Short Hood w/Brake Wheel - SP Lights
261	G40385.01	Cab - Dash-2, SP Modified L-Window, Late
263	G40330.01	Whip Antenna Base
277	G40379	Walkway - GP38-2/40-2 w/Stepped Sidesill, Notched Steps SP Square Jacking Pads
278	G68223.03	Drop Step - Etched
283	G40343.05	Short Handrail - Left, Late (for Notched Stepwells)
285	G40357	EMD Brakewheel
288	91588	Gyralight - Single
291	90618.601	Pyle Gyralight Lens - Single (SP, Red U.D.E.)
293	90614.1057	Horn - Nathan KSLA (All Trumpets Forward)
295	90614.1160	Horn - Leslie S-3 On Bracket
298	G40281.04	Cab Side Mirror - Medium
300	G40275.02	Inertial Intake Grilles, GP38-2/39-2/40-2, Late (Top & Bottom Ribs)
307	G40343.04	Long Handrail - Left SP (2 Short Stanchions)
311	95354.01	Battery Box Door - Dash-2, Early, Bolted Battery Box Door, Short Louver Early Hinged Under Cab Access Door, Left
312	95339.01	Battery Box Door - Dash-2, Bolted Battery Box, Long Louver, No Stiffening Rib & Lift Off Hinge Under Cab Access Door Left
316	95338	ECAFB, Dash-2 Late (Welded)
319	90614.1092	Bell - Hood Side Mount
320	G40331.12	Fuel Tank Breather Pipe, 2600Gal Tank, Front, Angled
321	G40331.13	Fuel Tank Breather Pipe, Short Rear, Left
323	G40331.10	Breather Downpipe - Rear V3
324	G40394.05	Fuel Tank Breather Pipe - 1700Gal Tank, Front, Angled
326	G40331.17	Breather Up-Pipe, Short - 3600Gal Tank
328	G40331.19	Waste Tank, Angled - Fuel Tank End Mount
327	G40331.09	Breather Downpipe - V1
328	G40331.11	Fuel Tank Vertical Sight Glass - Staggered Gauges (SOU)
329	G40394.04	Fuel Tank Sight Glass - 1700Gal Tank
341	G63446.02	Headlight - Dual Pyle Gyralight w/ Glare Shield, Numberboard Mount
345	G40317.01	Ditchlight - Pilot Mounted
346	G68251.02	Ditchlight Lens - Pilot Mount
347	G40295	MU Hose Catch Tray - No Footboard, w/ Bottom Reinforcing Strip
348	G40296	Snow Plow - Canadian National, Medium
349	90618.017	Snowplow - Tall
350	G40286.02	Trainline Hose w/Drop Elbow
351	G40291.02	Coupler Cut Lever - Late (w/ Loops); GP38-2, GP39-2, GP40-2, Phase I GP50
354	G40283.04	SP Rear Light Housing - As-Built
357	G40343.01	Front End Rail - Blunt Anticlimber w/ "Breakaway" Stanchions

GP40-2/GP40P-2

361	95354.02	Battery Box Door - Dash 2, Early Bolted Battery Box Door, Short Louver Early Hinged Under Cab Access Door Right
362	95339.02	Battery Box Door - EMD Standard, Intermediate Dash-2, Right
364	G40290.05	Prime Air Filter - Primary (Large), w/Piping
365	G40290.07	Salem Air Filter w/Pipe - Small
367	G40290.04	Prime Air Filter - Secondary (Large), w/ Piping
369	G40305.01	Front Anticlimber (GP38-2/39-2/40-2), Blunt, w/out Supports Use w/Pilot Face Ditch Lights
372	91591	Cab Vent - Rectangular, Cab Side Mount
374	G40343.02	Short Handrail - Right, Late (for Notched Stepwells)
379	91592.01	Air Conditioner Body, Vapor
383	G40291.03	Coupler Cut Lever, Late w/ Loops For use w/Pilot Mount Ditch Lights; GP38-2, GP39-2 GP40-2, Phase I GP50
384	91592.03	Air Conditioner Side Plate - Vapor, Right
387	G40339.04	Cab Side Plate - Welded, No Arm Rest
388	91592.02	Air Conditioner Side Plate - Vapor, Left
392	G40343.06	GP38-2/39-2/40-2 Long Rail - Right
393	G40396	2600Gal Fuel Tank - MoPac
395	G40398	3200Gal Fuel Tank
396	G40395	2600Gal Fuel Tank
400	G63850.02	48" Q-Fan Blade
402	G40312.01	Q-Fan, 48" Single-Speed (1-Conduit)
404	G63850.04	48" Q-Fan Pin
408	G68243.01	Stepwell Light - Left
409	G68243.02	Stepwell Light - Right
410	G40305.02	Front Anticlimber - Blunt w/Supports
411	G40305.03	Front Anticlimber Support Plates
412	90618.049	Communications Antenna Ground Plane - Dust Bin Side Mount
413	G40287.05	Walkway Toolbox - SP GP38-2 and GP40-2
414	G40281.14	Eyebolt
415	G40282.03	Cab Front Glass - Engineers Side, Modified L-Window
416	G40331.18	Fuel Gauge - Stem Mounted
417	G40282.02	Cab Side Wind Deflector - No Mirror
418	G40343.05	Rear End Rail, GP38-2/39-2/40-2 w/Breakaway Stanchions
419	G40281.10	Lift Tab, Large - GP40P-2
420	G40345.04	Long Handrail - Right, GP38-2/39-2/40-2
421	95294	88" Nose w/Brake Wheel - Blanked SP Lights
422	95307	81" Nose w/Ratchet Brake - SP Lights
423	G40285.01	GP40P-2 Steam Generator Hatch
424	G40286	GP40P-2 Steam Generator Hatch - Blanked
425	G40285.02	Steam Generator Intake Dome - GP40P-2
426	95335	Exhaust Silencer, Late - GP40-2/GP50, SD40-2
427	G40257	Non-Dynamic Brake Hatch - GP40-2 w/Power Assembly Access Doors
428	G40258.01	Dynamic Brake Hatch - GP40P-2
429	95317	88" Nose w/Ratchet Brake - Dual Gyalright
430	G40239	Walkway - GP38-2/39-2/40-2, No Anticlimbers or Pilot Notches w/Lifting Slots, Std. Steps
432	G40245	Walkway - GP40P-2
433	G40240	Walkway - GP38-2/39-2/40-2, w/ Anticlimber, Notched Stepwells for 81" Short Hoods
434	G40305.08	Anti-Climber - Rear, GP40P-2
435	G40287.02	Walkway Duct Extension - Long
437	90614.1162	Horn - Nathan P3 on Bracket
439	G40219	Body - GP40-2 Phase III - Corrugated Grills, Q-Fans, Angled Blower No Rear Number Boards or Class Lights
440	G40217	Body - GP40-2 Phase IIb, Early - Corrugated Grills, Q-Fans, Rounded Blower Rear Number Boards & Class Lights
441	G40218	Body - GP40-2 Phase IIb, Late - Corrugated Grills, Q-Fans, Rounded Blower No Rear Number Boards or Class Lights
442	G40216	Body - GP40-2 Phase IIa, Corr. Grills, Std. Fans, Rounded Blower Rear Number Boards & Class Lights
443	G40215	Body - GP40-2 Phase I - Chickenwire Grills, Standard Fans
444	G40221	Body - SP GP40P-2, Late - Blanked Class Lights
445	G40345.01	Long Handrail - GP40-2, Left - 2 Short and 2 X-Tall Stanchions
446	G40346.02	Long Handrail - Left GP40P-2 SP
447	95340.01	Battery Box Door - SP Late Bolted Battery Box Door, Large Lift Off Hinge Split Under Cab Access Left
448	95355.01	Battery Box Door - SP Split, Early, Left
449	G40233.02	Bell, Cab Roof Mount (SP/SSW)
450	G40331.22	Breather Downpipe
451	G40331.20	Water Fill Pipe, GP40P-2 - Left
452	95308	81" Nose w/ Ratchet Brake - Dual Gyalright
453	G40331.21	Water Fill Pipe, GP40P-2, Right
454	95288	81" Nose w/ Ratchet Brake - Blanked SP Lights
455	G40262	Underframe, GP40P-2
456	90618.048	Blanking Plate, Dual Gyalright Flush Mount (Number Board Housing)
458	G68250	Snowplow - Tall
460	G68235	Chessie Rock Pilot
461	G40298	Snow Plow - SP Tall w/ Steam Line Door
462	G40288.03	Trainline Pipe w/Elbow - Front
463	G40283.07	SP Rear Light Bracket - Gyalright, Blanked
464	G40283.09	SP Rear Light Bracket - Oscitrol, Blanked
465	G40345.02	Rear End Rail - GP38-2/39-2/GP40-2 w/Std. Stanchions
466	G40346.03	REAR END RAIL, GP40P-2
467	95340.02	Battery Box Door, SP Late - Bolted Battery Box Door, Large Lift Off Hinge Split Under Cab Access Right
468	95355.02	Battery Box Door, SP Split, Early, Right
469	G40256	Non-Dynamic Brake Hatch, GP40-2
471	G40346.04	Long Handrail, Right - GP40P-2 SP
472	G40332.01	1500G + 1500G Water/Fuel Tank, GP40P-2, Left
473	G40332.02	1500G + 1500G Water/Fuel Tank, GP40P-2, Right
474	G40241	Walkway, GP40-2 Ph.III - Straight Sill w/Anticlimber
481	G40345.03	Front End Rail - Blunt Anticlimber, GP38-2/39-2/GP40-2 w/Std. Stanchions
482	G40329	Round Vent
483	G62327.03	Grab Iron - Pilot Face (MU Holder)
486	G40323.01	Air Line, Rooftop Mounted Bell
487	G40305.07	Anticlimber, Blunt - GP40P-2 Front
488	G40346.01	Front End Rail GP40P-2
489	G40291.06	Front Coupler Cut Lever, Angled, Early w/o Loops, SP - GP40P-2
490	G40291.07	Front Coupler Cut Lever, Angled, Late w/ Loops, SP - GP40P-2
490	G40284.01	Radiator Grill, GP40P-2 - Left
493	G40284.02	Radiator Grill, GP40P-2 - Right
494	91590	Cab Roof Vent - Square
495	G40328	Cab Roof A/C Power Conduit
496	G40321.04	CSX Angled Ditch Light Face - Left
497	G40321.03	CSX Angled Ditch Light Back - Left
498	G40321.02	CSX Angled Ditch Light Face - Right
499	G40321.01	CSX Angled Ditch Light Back - Right
502	G40283.11	Dual Oscitrol Light - no Glare Shields
505	G40264	Rear Weight
508	G40283.13	Dual Oscitrol Light w/Glare Shields
510	G40322	Walkway Spare Knuckle Box - Chessie
511	G40283.10	SP Rear Light Bracket - Oscitrol, As-Built
512	G40220	Body - SP GP40P-2, Early
513	G40368	Front Weight
515	G40275.07	Inertial Intake Grill - Cut for Shield
516	G40369.02	Canadian Ditch Light Lens
517	G40369.01	Canadian Ditch Light Housing
518	G40294.08	Brake Ratchet Housing - Canadian
519	G40294.09	Brake Ratchet Chain - Canadian
520	G40275.05	Inertial Intake Shield - Left
521	G40275.06	Inertial Intake Shield - Right
531	G63850.01	Two Speed "Q" Fan Housing
532	G40361	88" Low Hood, Canadian w/ Brakewheel and Nose Light
536	G40363	Body - GP40-2 SP w/Standard Fans
537	G40364	Body - GP40-2 SP w/"Q" fans
541	90614.0008	Cab Arm Rest, Large (UP)
542	G40281.16	Sunshade, Canvas (UP)
543	90614.1210	Horn, Leslie S-3L w/ Angled Mounting Bracket, UP (Between Rad. Fans)
544	90614.1381	MU Stand, Lift/W/ Aux. Receptacle, CP Rail
545	90614.1893	Snow Plow Pilot - CP Rail, rounded Rock Pilot
546	90614.0007	Reral Frog - Truck Mounted, UP

550	G40377.02	Battery Box Door - Chessie/CSX Open Mailslot w/Late Hinge, Right
551	G40377.01	Battery Box Door - Chessie/CSX Open Mailslot w/Late Hinge, Left
552	G40376.02	Battery Box Door - Chessie/CSX Open Mailslot w/Early Hinge, Right
553	G40376.01	Battery Box Door - Chessie/CSX Open Mailslot w/Early Hinge, Left
554	80515.08	Cab Front, Middle Glass - L Shape
556	G40393	Sunshade Track, Long, Standard
557	G40382.01	Cab - EMD Dash-2 Series, SP L-Window, Early, No Seam, W/Louvers L-Window, Front
558	G40394.02	1700Gal Fuel Tank Fuel Filler - Left
559	G40394.03	1700Gal Fuel Tank Fuel Filler - Right
560	G40394.01	1700Gal Fuel Tank - Body
561	90618.034	Sunshade w/ Rivet Strip
562	G40381.01	Cab - EMD Dash-2 Series, Std. Late, No Seam, No Louvers Standard 44-Window Front
563	G40383.01	Cab - EMD Dash-2 Series, SP L-Window, Late, No Seam, No Louvers L-Window Front
564	G40384.01	Cab - EMD Dash-2 Series, SP Modified L-Window, Early, No Seam W/Louvers, Modified L-Window Front
565	G40386	Sunshade Mounting Bracket - Short, Seabord/Chessie/CSX (use with sunshade G68223.10)
571	G40281.17	Cab Front Step
576	G40338.02	MU Receptacle - Pilot Face w/Backing Plate (EMD Standard)
582	G40405	Walkway - GP38-2/40-2, Early Standard Steps Late Cut Levers (w/ Loops)
587	G60594.01	Ditch Light - Round-Top, Deck Mount
588	G40283.15	Dual Oscitrol Light w/Glare Shields
589	G63446.01	Headlight - Cab Mounted, Standard Dual Sealed-Beam w/o Glare Shield
590	G40283.14	Dual Oscitrol Light - No Glare Shields
591	G66039	Plow, "Weedcutter" Type
593	90618.014	ATSF Comm. Antenna Ground Plane, Cab Mount - Angled Corners
594	90618.015	ATSF EOT Antenna Ground Plane, Cab Mount
595	G63450.12	SP Spare Knuckle & Box - Truck Mount
603	G40418	Walkway GP38-2, GP39-2, GP40-2 - Late w/ Front Anticlimber Standard Jacking Pads, Pilot Face Lifting Slots & Notched Stepwells - 88" Short Hoods
604	G40417	Walkway GP38-2, GP39-2, GP40-2 - Late w/ Front Anticlimber Standard Jacking Pads, and Notched Stepwells - 88" Short Hoods
606	95356.01	Battery Box Door, Chessie/CSX/DRGW - Late Hinges w/Screened Mailslots, Left
607	95356.02	Battery Box Door, Chessie/CSX/DRGW - Late Hinges w/Screened Mailslots, Right
608	90614.0003	Speed Recorder - Early
609	90614.1205	Horn - Nathan M-5 w/Clearance Bracket
610	90614.1207	Horn - Nathan P-3 On Bracket w/Staggered Trumpets
611	91586.4	Sindair Antenna Sindair Small - EOT
612	G63454.01	Air Conditioner Body - Prime
613	G63454.02	Air Conditioner Side Plates - Prime
614	91793	MU Hose Catch Tray w/ Footboard
615	94783	88" Low Nose w/Brake Wheel - No Lights
616	95282.01	81" Low Nose w/Brake Wheel - CNW Gong Bell
617	95284.01	81" Low Nose w/Ratchet Brake - CNW Gong Bell
618	95286	81" Low Nose w/Ratchet Brake - NP/Frisco Single Gyalright
619	95289	88" Low Nose w/Brake Wheel - ATSF Low-Nose Lights
620	95292	88" Low Nose w/Brake Wheel - NP/Frisco Single Gyalright
621	95293	88" Low Nose w/Ratchet Brake - NP/Frisco Single Gyalright
622	95301	81" Low Nose w/Brake Wheel - No Lights
623	95302	81" Low Nose w/Brake Wheel - EMD Lights
624	95303	81" Low Nose w/Brake Wheel - SP Lights
625	95304	81" Low Nose w/Brake Wheel - Dual Gyalright
626	95306	81" Low Nose w/Ratchet Brake - EMD Lights
627	95313	88" Low Nose w/Brake Wheel - EMD Lights
628	95314	88" Low Nose w/Brake Wheel, Dual Gyalright
629	95315	88" Low Nose w/Ratchet Brake - EMD Lights
630	95316	88" Low Nose w/Ratchet Brake - SP Lights
632	G68223.10	Sunshade, Short (SBD/Chessie/CSX; use with sunshade bracket G40386)
633	G68230.01	Cab Signal Box Body
634	G68230.02	Cab Signal Box Top
635	G68233	Snowplow - Low, Pointed (KCS, SLSF, etc.)
636	G68287.01	Cab Side Plate - 2 Pane All Weather Window
637	G68287.02	Cab Side Plate - 3 Pane All Weather Window
638	G62372	Sloped Bearing Cap
639	G62373	Square Bearing Cap
640	G62374	Square Bearing Cap For SP/RC
700	90614.2018	Flange Lube Cabinet - Walkway Mount
701	90617.103	Square Knuckle Box, Open - Chessie System
702	90614.1208	Horn - Nathan P-3, All-Chimes Forward
703	G66042.07	Single Gyalright Blanking Plate
704	G66042.08	Dual Gyalright Blanking Plate
800	G40365	Body, GP40-2 Phase III - Q-Fans, Corrugated Grills, Angled Blower Housing w/Rear Number Boards and Class Lights
801	90618.093	ACL Label Plate, Sill Mount
900	G40331.34	Fuel Tank Top Filler Plate .417" / 10.60mm
901	G40331.35	Fuel Tank Top Filler Plate .266" / 6.76mm
902	G40421.01	Cab - EMD Dash-2 Series, Early, No Seam, w/Louvers For Units with High Short Noses
903	G40422.01	Cab - EMD Dash-2 Series, Late, No Seam, No Louvers For Units with High Short Noses
905	G68224.02	Battery Box Door - Horizontal "Split" Battery Door, Lift-Off Hinge on Sub-Base Door, Right, Conrail
906	G40430	Walkway - GP38-2/40-2, Early "Non-Notched" Steps, w/Pilot Face Corner Notches (For Looped Cut Levers) w/Pilot Mounted Ditch Lights
907	G40431	Walkway - GP38-2/39-2/40-2, Late w/Front Anticlimber Standard Jacking Pads, Pilot Face Lifting Slots
908	G40432	Walkway - GP38-2/40-2, Early "Non-Notched" Steps, w/Pilot Face Corner Notches (For Looped Cut Levers) w/Pilot Mounted Ditch Lights, No Cut Lever Mounting Holes
909	G40433	Walkway - GP40-2 Phase III w/Front & Rear Pilot Mounted Ditch Lights
1001	G40434	Walkway - GP40-2 Phase III w/Front Pilot Mounted Ditch Lights
1101	G40414.01	Dynamic Brake Housing Late, V2
1103	G40280.13	Antenna Conduit SP/SSW GP40-2 - V2
1104	G40280.15	Cab Roof Antenna Conduit SP - V2
1106	G40369.03	Prime 8911 Stratolite Beacon - Base (Long)
1108	95337.01	ECAPB, Early (Stand-Off) - Front
1109	95337.02	ECAPB, Early (Stand-Off) - Rear
1112	80515.11	EMD Cab Side Windows - One Piece Use w/etched mirrors
1121	G40441	Electronic Parking Brake
1122	G40442	EMD Cab Doors - Rebuilt, Thicker Version
1123	G40443	Blower Housing, Standard 35-Line (No Ribs)
1124	G40444	81" Nose w/Ratchet Brake, No Class Lights
1125	G40445	81" Nose w/Brakewheel, No Class Lights
1126	G40446	88" Nose w/Ratchet Brake, No Class Lights
1127	G40447	88" Nose w/Brakewheel, No Class Lights
1128	G40448	88" Nose w/Ratchet Brake - Oscitrol Light
1129	G40449	88" Nose w/Brakewheel - Oscitrol Light
1130	G40450	81" Nose - No Brake, No Class Lights
1131	G40451	88" Nose - No Brake, No Class Lights
1132	G40452	Headlight, Dual Gyalright w/Glare Shields, Numberboard Mount, BLE
1134	G40454	81" Nose - No Brake, Grabiron on Left - CR
1135	G40455	81" Nose - No Brake, Bugeye Markers (CR 6961-6970)
1136	G40456	81" Nose - Ratchet Brake, Grabiron on Left - CR
1137	G40457	88" Nose - Ratchet Brake, Grabiron on Left - CR
1138	G40458	88" Nose - Ratchet Brake, Grabiron on Left; Bugeye Markers - CR
1139	G40459	88" Nose - Brakewheel, Grabiron on Left - CR
1143	G40463	Rear Light, Single Bulb - WP
1144	G40464	Rear Light, Twin Sealed-Beam, Horizontal - WP
1145	G40465	Rear Light, Twin Sealed-Beam, Vertical - WP
1146	G40466	88" Nose w/Ratchet Brake, Grabiron on Left; No Markers - CR
1147	G40467	88" Nose w/No Brake, Grabiron on Left; With Class Lights - CR
1156	ATHP66149	Speaker Housing Gasket
1157	G68289.01	Saturn 6552 Xenon Strobe - Base
1158	95350	All-Weather Cab Window
1161	G67769	Waste Retention Tank

G40280	Wireform Set
G68287	Cab Side Plate set - For 2 & 3 Pane All Weather Windows
G40339	Dash-2 Cab Side Set #2
80515	Window Set
G40282	Modified L-Window Set
G40283	Headlight Housing Set
G63911	Cab Interior Set - Standard
G40387	Cab Assembly - EMD Dash-2 Series, Std. Early No Seam, With Louvers, Std. 4-Window Front
G40388	Cab Assembly - EMD Dash-2 Series, Std. Late No Seam, No Louvers, Std. 4-Window Front
G40389	Cab Assembly - EMD Dash-2 Series, SP L-Window Early No Seam, With Louvers, L-Window Front
G40390	Cab Assembly - EMD Dash-2 Series, SP L-Window Late No Seam, No Louvers, L-Window Front
G40391	Cab Assembly - EMD Dash-2 Series, SP Modified L-Window Early (No Seam, With Louvers, Modified L-Window Front)
G40392	Cab Assembly - EMD Dash-2 Series, SP Modified L-Window Late (No Seam, No Louvers, Modified L-Window Front)
G40421	Cab Assembly - EMD Dash-2 Series, Early (No Seam, With Louvers) For Units with High Short Noses
G40422	Cab Assembly - EMD Dash-2 Series, Late (No Seam, No Louvers) For Units with High Short Noses
G40371	Prime Stratolite Beacon Set
G40281	Etching Set
G40330	Antenna Set #2
G40274	Dust bin Set
G40293	Blower Housing Set
G40291	Coupler Cut Bar Set
G40278	MU Stand Set
G40288	Trainline Set
G40265	Cab Sub-Base Set
G40266	Battery Box Door Set #2
G40287	Walkway Tool Box Set
G67034	MU Hose Set
G40276	Air Tank Set
G40290	Plumbing Set (Plastic Parts)
G40317	Pilot Ditch Light Set
G40345	GP40-2 Handrail Set - Angled Blower Housing**
G40305	Anti-Climber Set
G40321	CSX Deck mounted Ditch Light Set
G40346	GP40P-2 Handrail Set**
G40326	Ditch Light Set - Round Top
G40320	Ditch Light Set - EMD Flat Top
G40372	Step Well Light Set
G63450	Spare Knuckle Set
G63838	Wire Lock Set
G40309	Sanding Line Set - 2 Axle
G40310	Sanding Line Set - 4 Axle
G40331	Fuel tank Detail Set
G40394	1700 Gallon Fuel tank Set
G40370	Power Truck Assembly - Blomberg "M" w/Elliptical Springs & Hyatt Bearings
G40375	Power Truck Assembly - Blomberg "M" w/Rubber Springs & Hyatt Bearings
G40401	Power Truck Assembly - Blomberg "M" w/Rubber Springs & Timken Bearings
G62399	Power Truck Assembly - Blomberg "B"
G40302	Blomberg "M" Sideframe Set w/Elliptical Springs & Hyatt Bearings
G40303	Blomberg "M" Sideframe Set w/Rubber Springs & Timken Bearings
G40373	Blomberg "M" Sideframe Set w/Rubber Springs & Hyatt Bearings

**Due to the many different handrail variations possible on these models, it is impossible to list them all. If you are in need of a specific handrail set, please contact our Toll Free Athearn Product Support line at 1-877-422-9316, or via e-mail at parts@athead.com